

Expand LinkWall Set-up Instructions

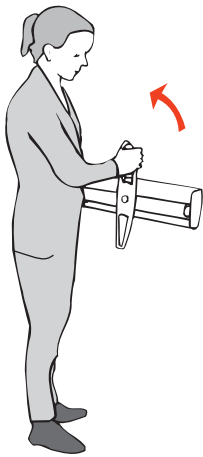

1

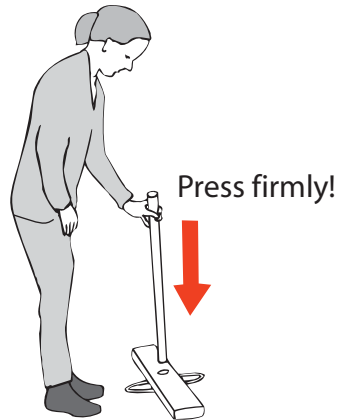

2

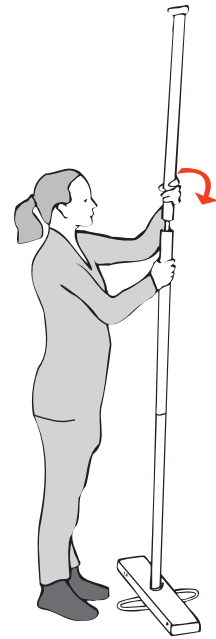

3



4

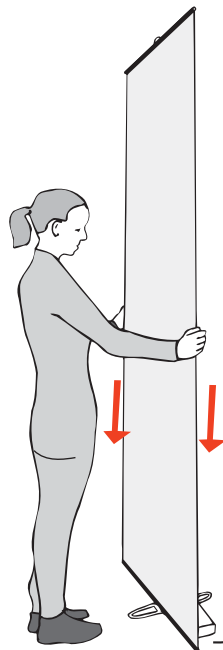

click

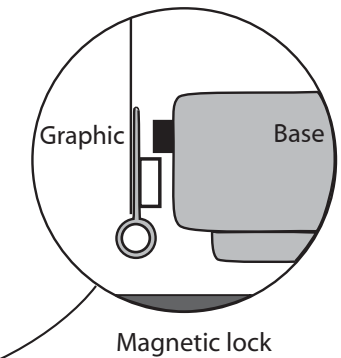

5

Set-up flex link panel

(for taller versions a ladder is recommended)

86 5/8" (220 cm) height

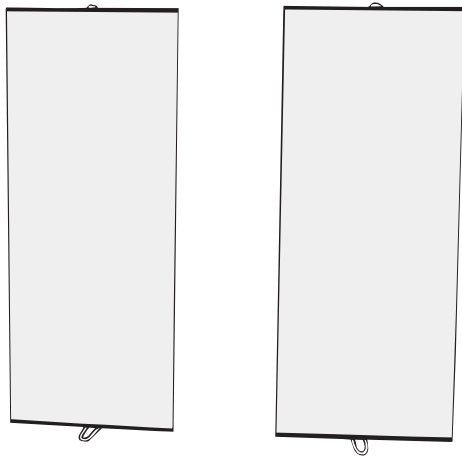

1

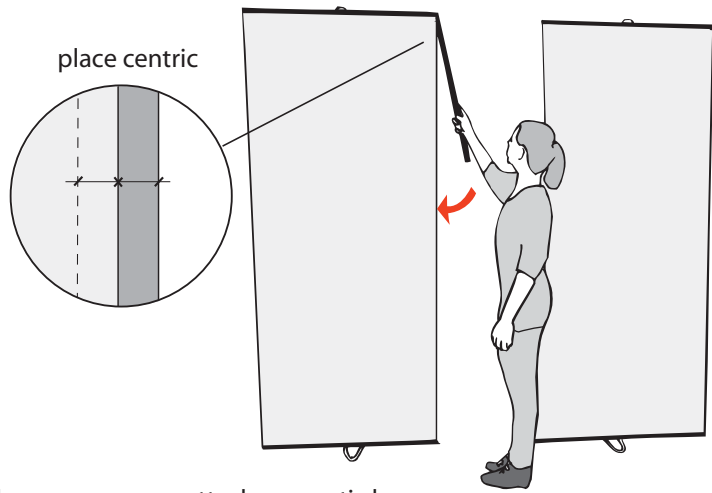

attach magnetic bars

2

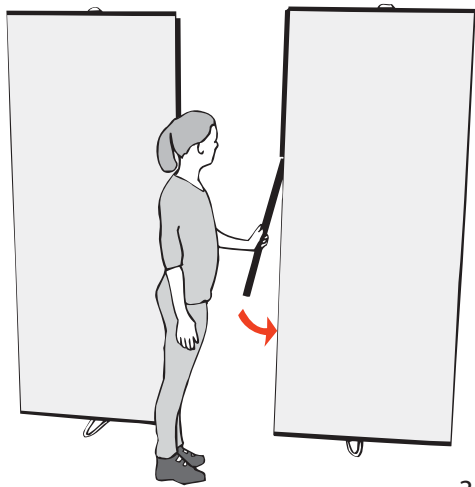

...along both panel sides

3

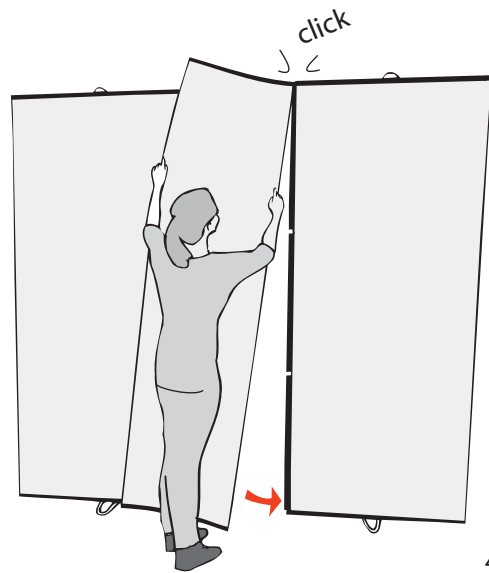

4

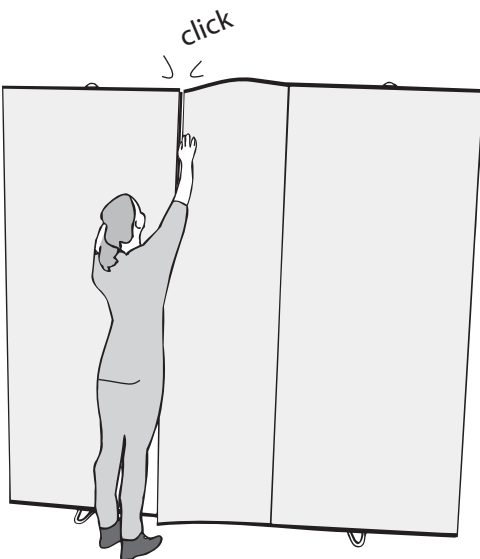

5



6

How to align graphics

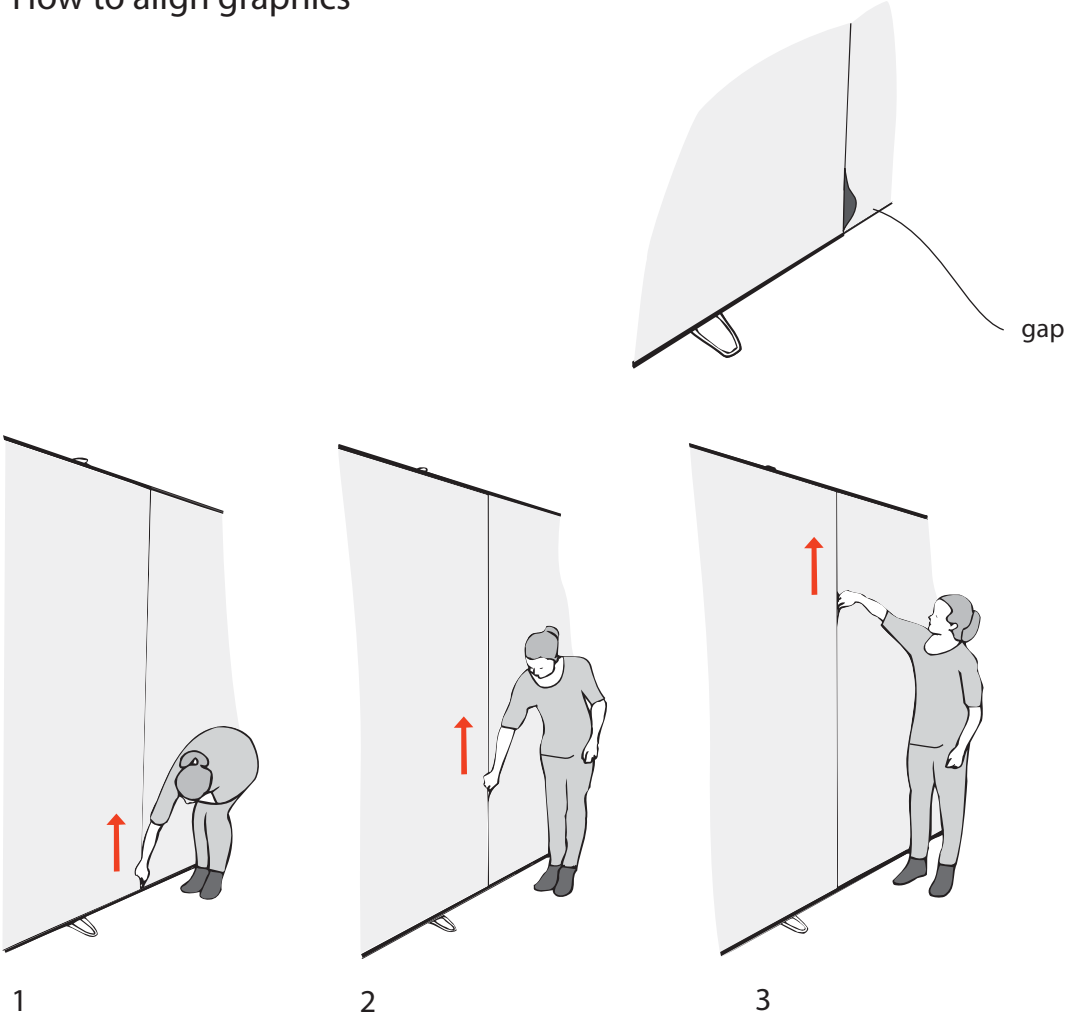

How to attach end panel (optional)

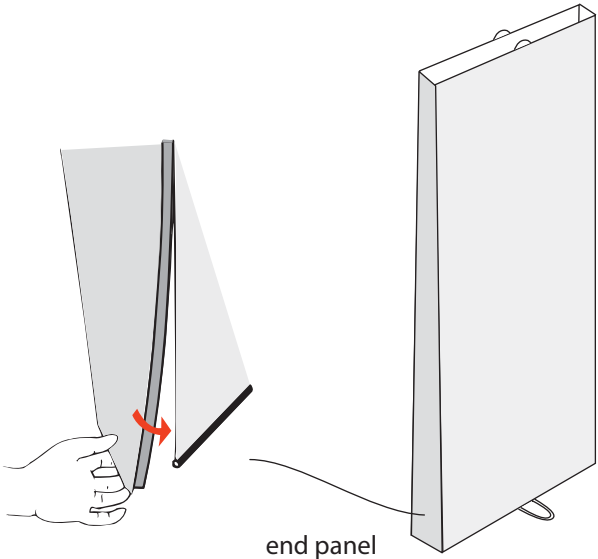

Attaching spotlights

Expand Spotlight 200W/LED

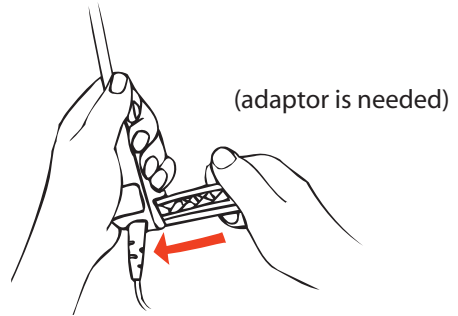

Expand Spotlight 50W

